

King Street- Bradlee Safety & Mobility Enhancements

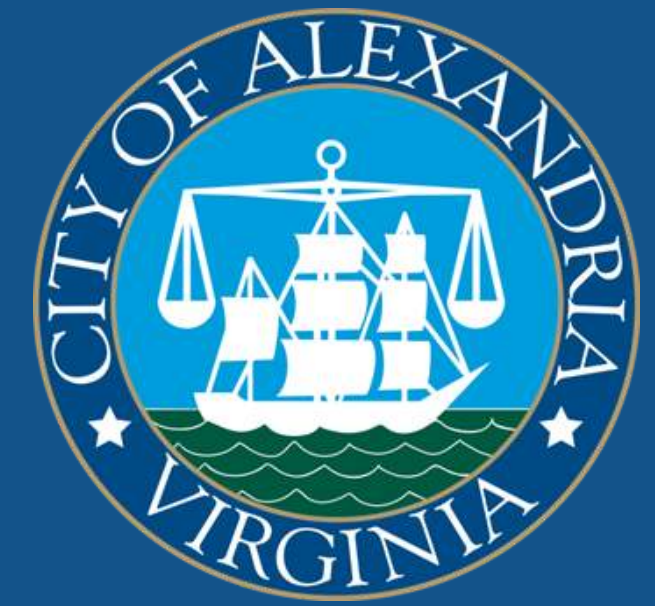

04-29-2024 Traffic & Parking Board

City of Alexandria

Department of Transportation & Environmental Services

AGENDA



Project Location

Project Goals

Project Timeline

Community Engagement

Design Alternatives

Design Refinements

Interim Improvements

Upcoming Activity

Project Location

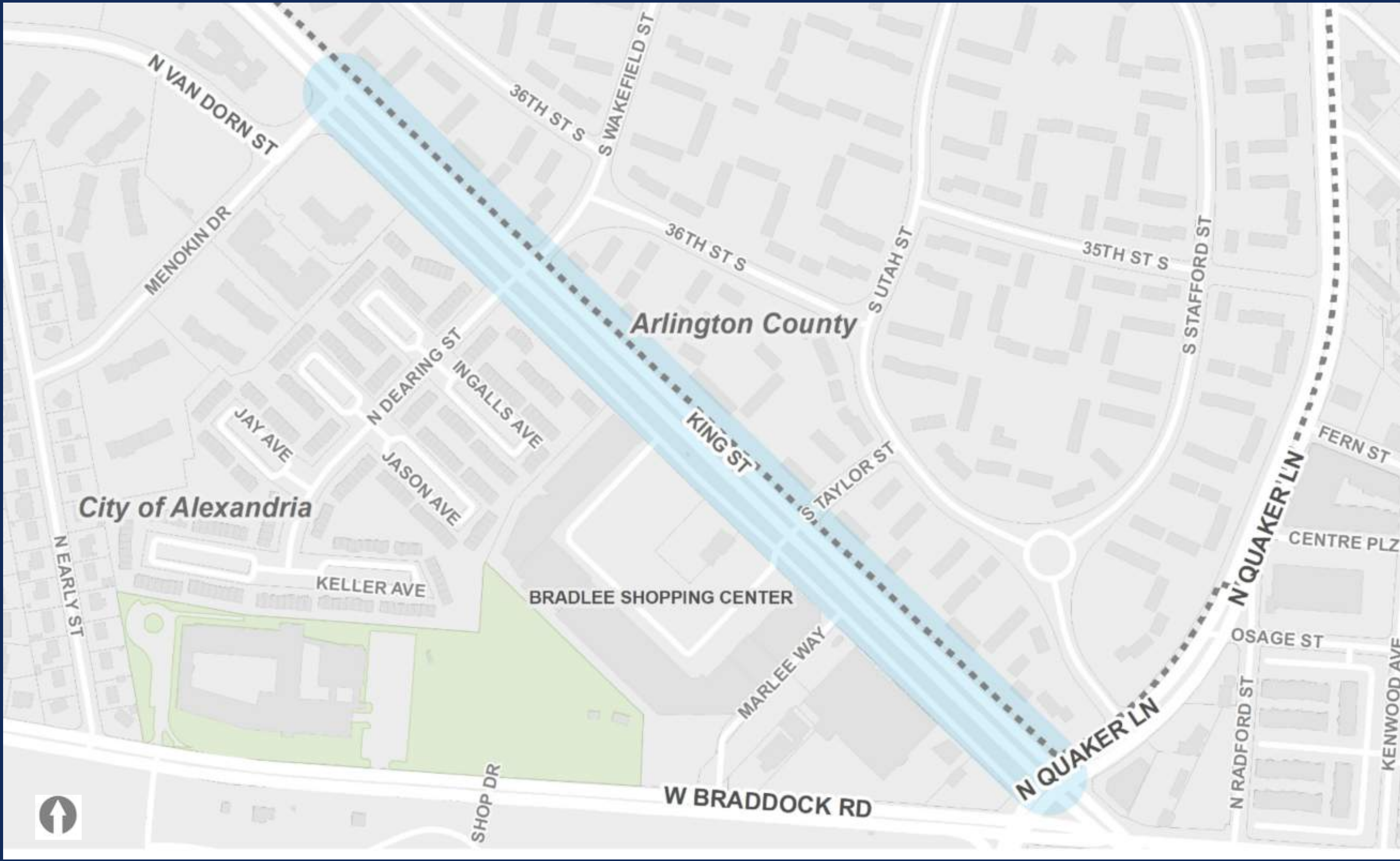

Legend / Guía

- County Boundary / Límite del Condado
- Study Corridor / Corredor del Estudio
- Open Space / Espacio Abierto

Project Goals

Improve mobility, safety, and access for all roadway users of all ages, abilities and modes of travel.

Install safer pedestrian access and bicycle facilities to connect to surrounding network.

Maintain or enhance existing transit facilities.

Improve existing stormwater treatment.



Project Timeline

We Are
HERE

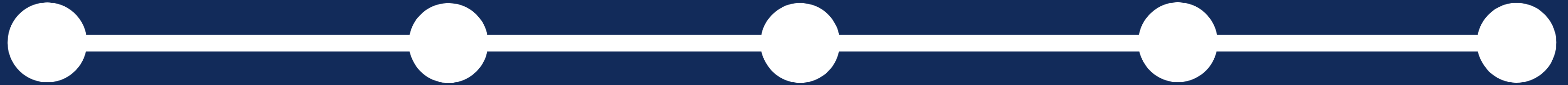

Project Initiation

- Data Gathering
- Staff Analysis

Issue Identification

- Phase 1 community engagement
- Design Team Hired
- Data Analysis

Concept Development

- Initial Concept Development
- Phase 2 community engagement
- Data Analysis

Concept Refinement

- Continued Analysis
- Phase 3 community engagement
- Concept Selection
- Short-Term Improvements

Seek Construction Funding

- Identify applicable funding sources and prepare applications

Summer 2023

Fall 2023

Winter 2024

Spring 2024

Summer 2024



Community Engagement

2 Feedback Forms

Over 1,000 interactions



In Person Events

Pop-Ups, Community Festival & Bus Stop chats

8 Staff Presentations

Meetings with HOA & Civic Associations

Digital Engagement

Social Media Posts, direct email notifications, website updates

Existing Typical Cross -Section

Bradlee Shopping Center

Fairlington

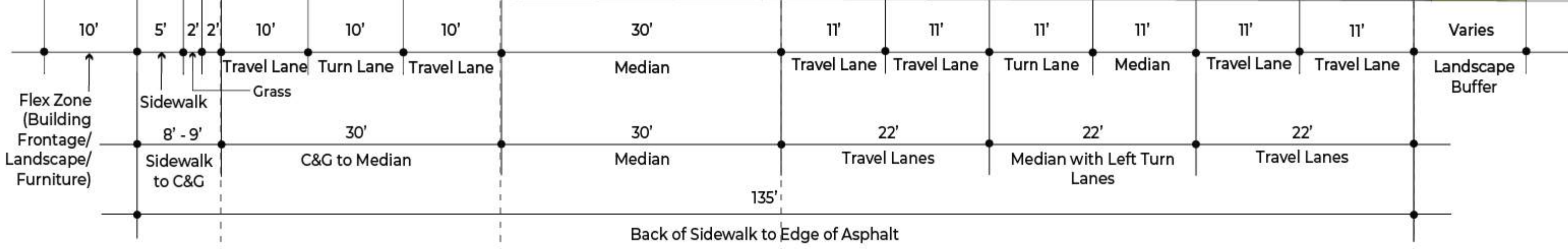
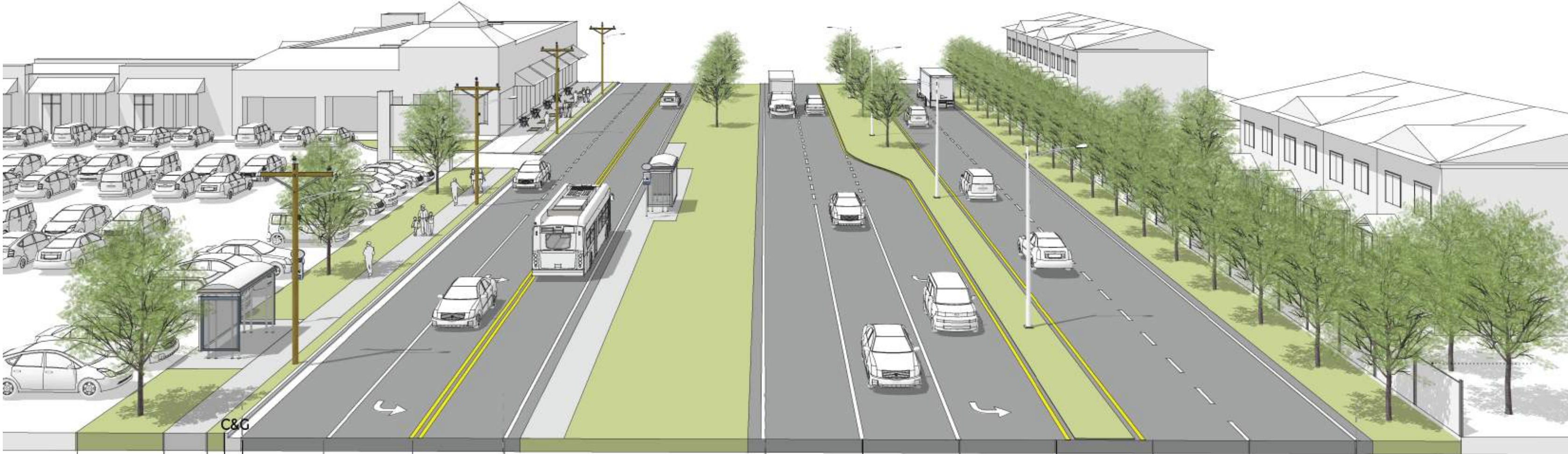

Alternative 1: Two-Way Traffic with Transit

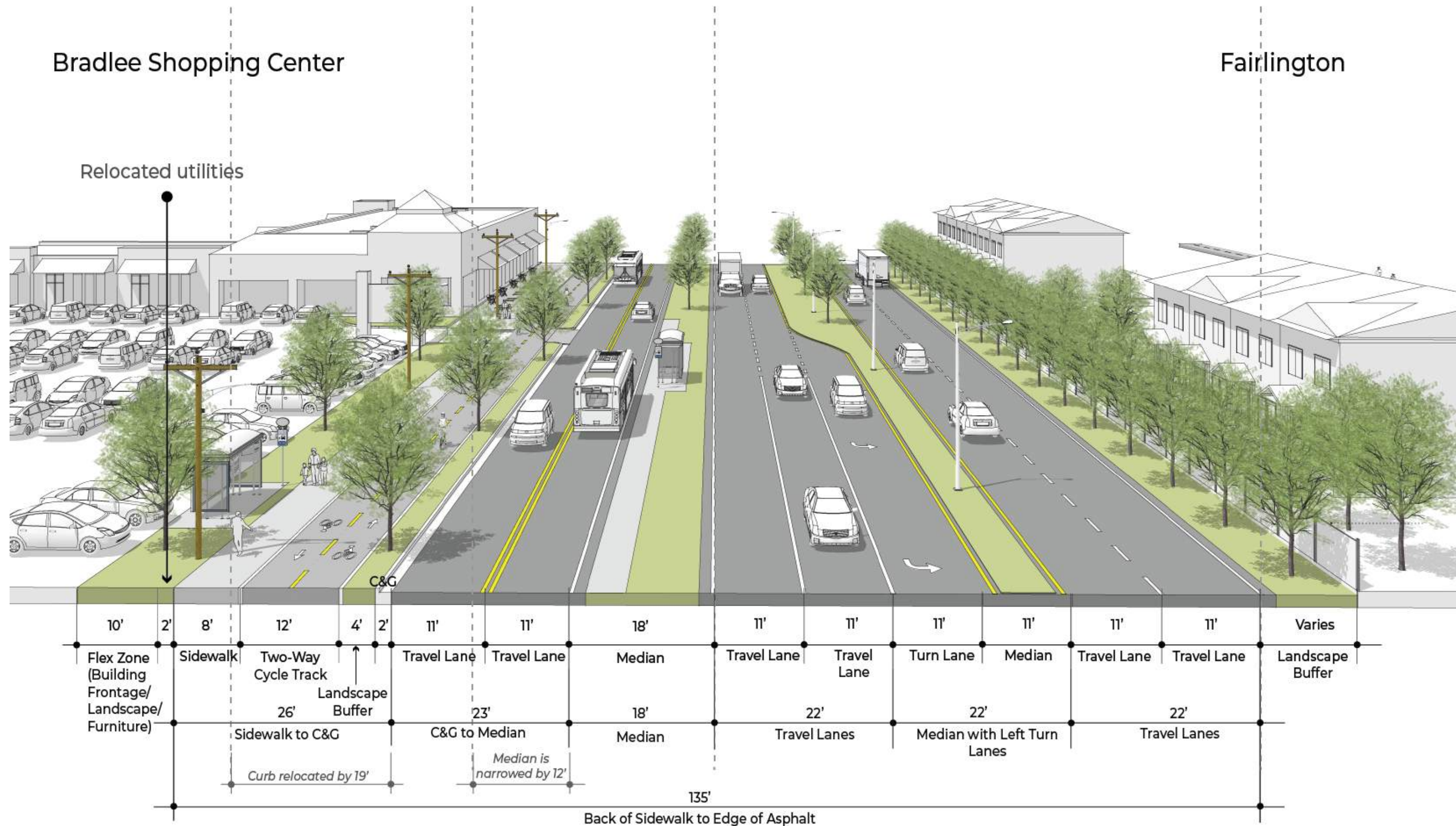

Alternative 2: One-Way Traffic & Bus Lane

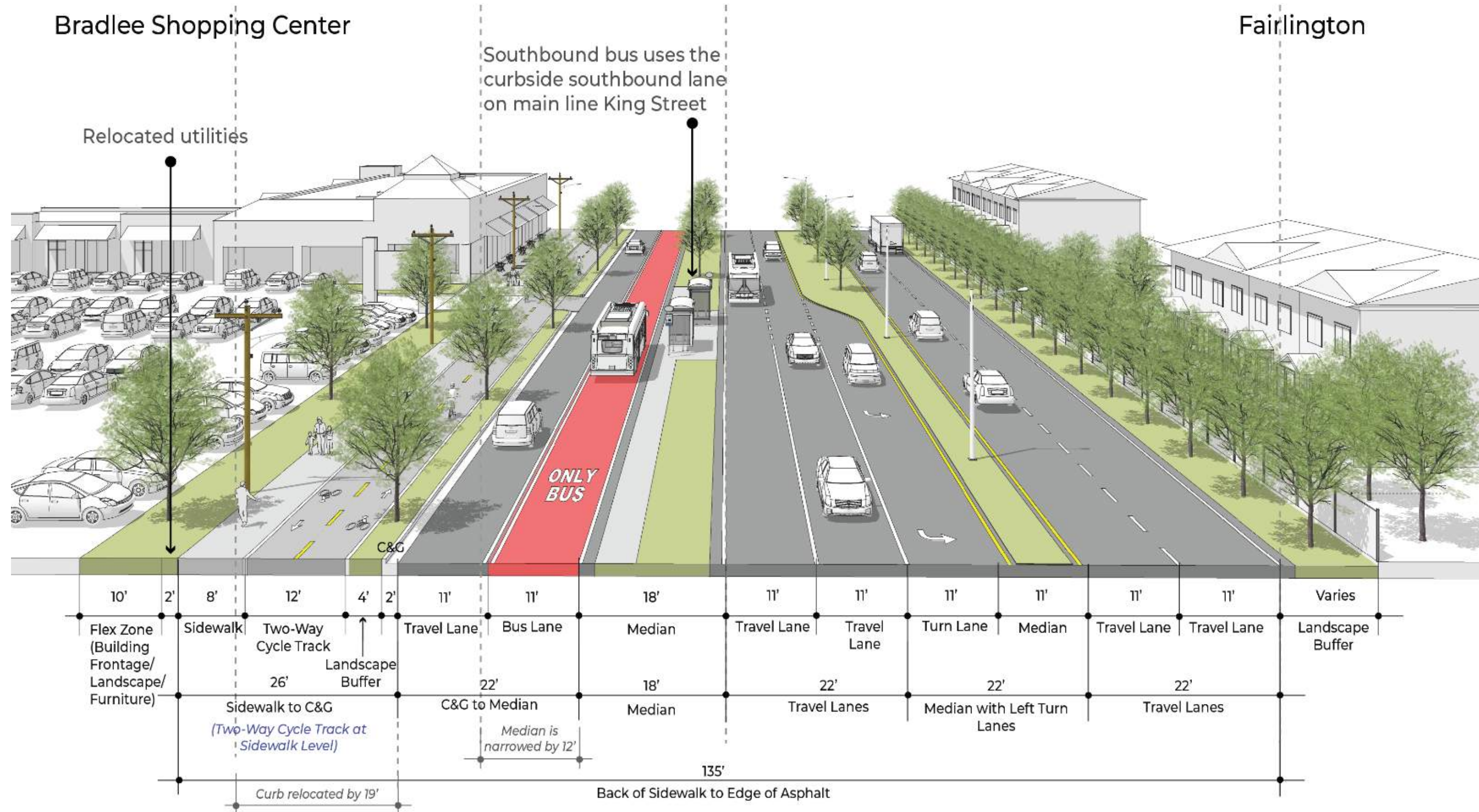

Alternative 3: One-Way Shared Traffic

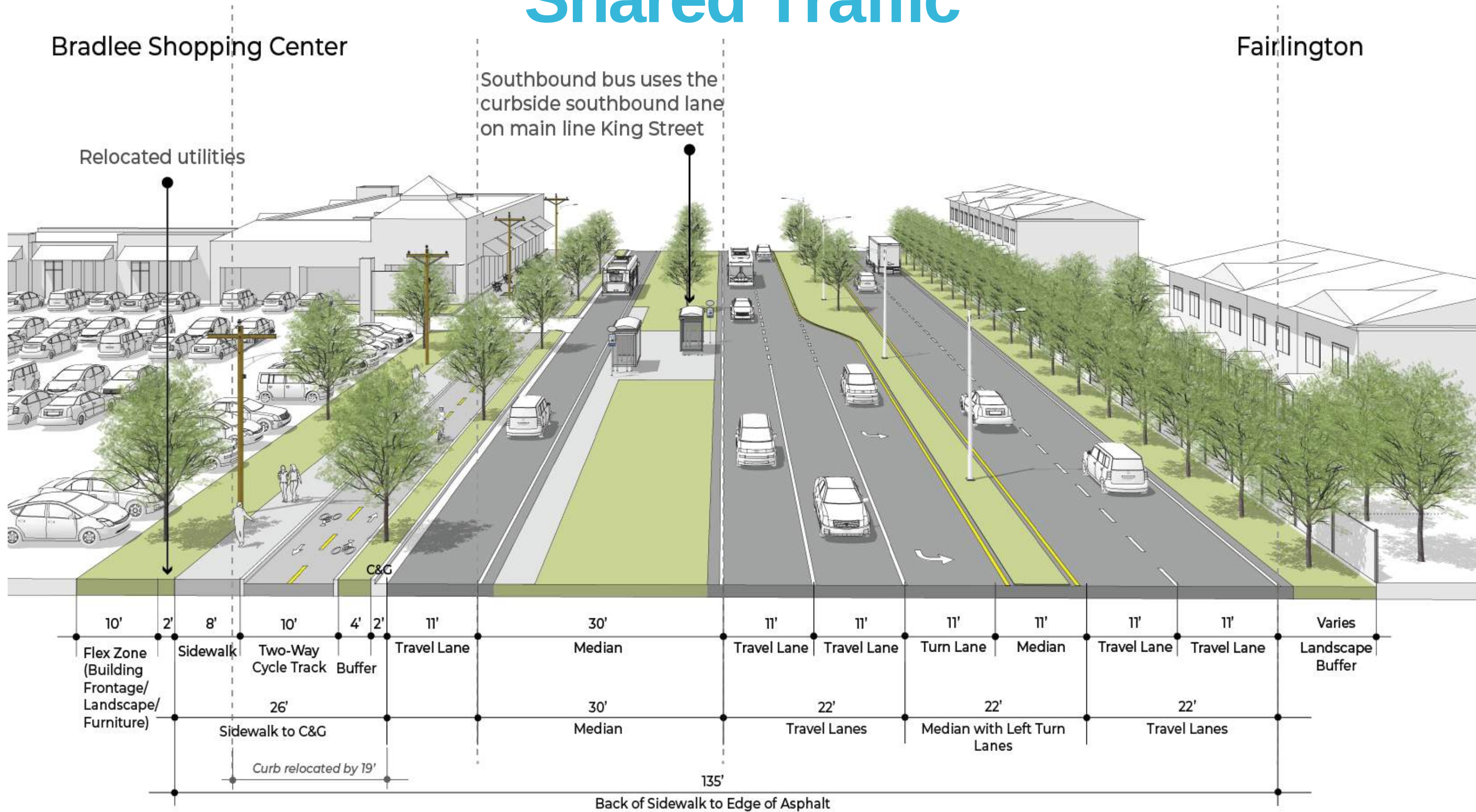

Full Corridor Design

Alternative 1: Two-Way Traffic with Transit

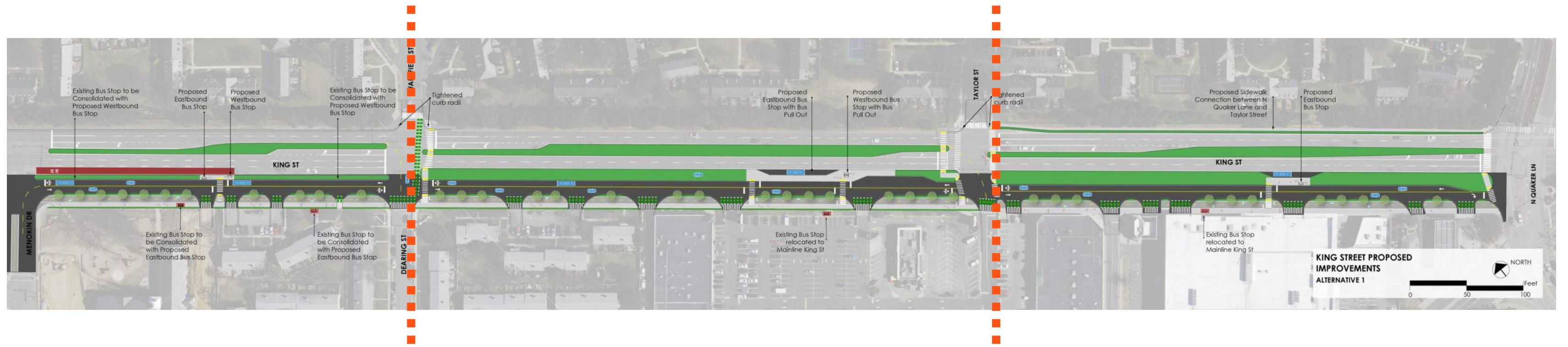

Menokin Dr

N. Dearing St

Taylor Street

N. Quaker Ln

Alternative 1: Two-Way Traffic with Transit

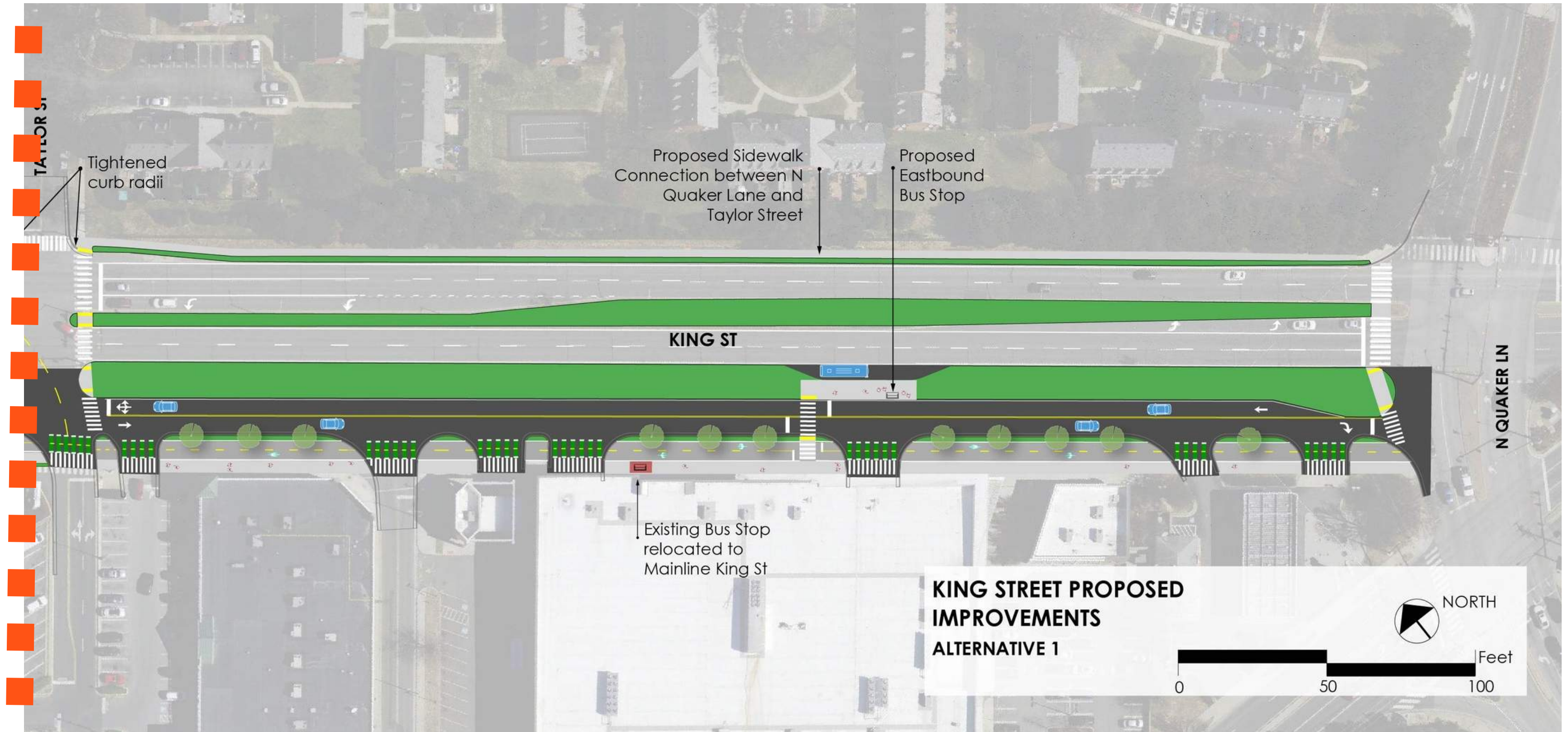

Taylor St

N. Quaker Ln

Alternative 1: Two-Way Traffic with Transit

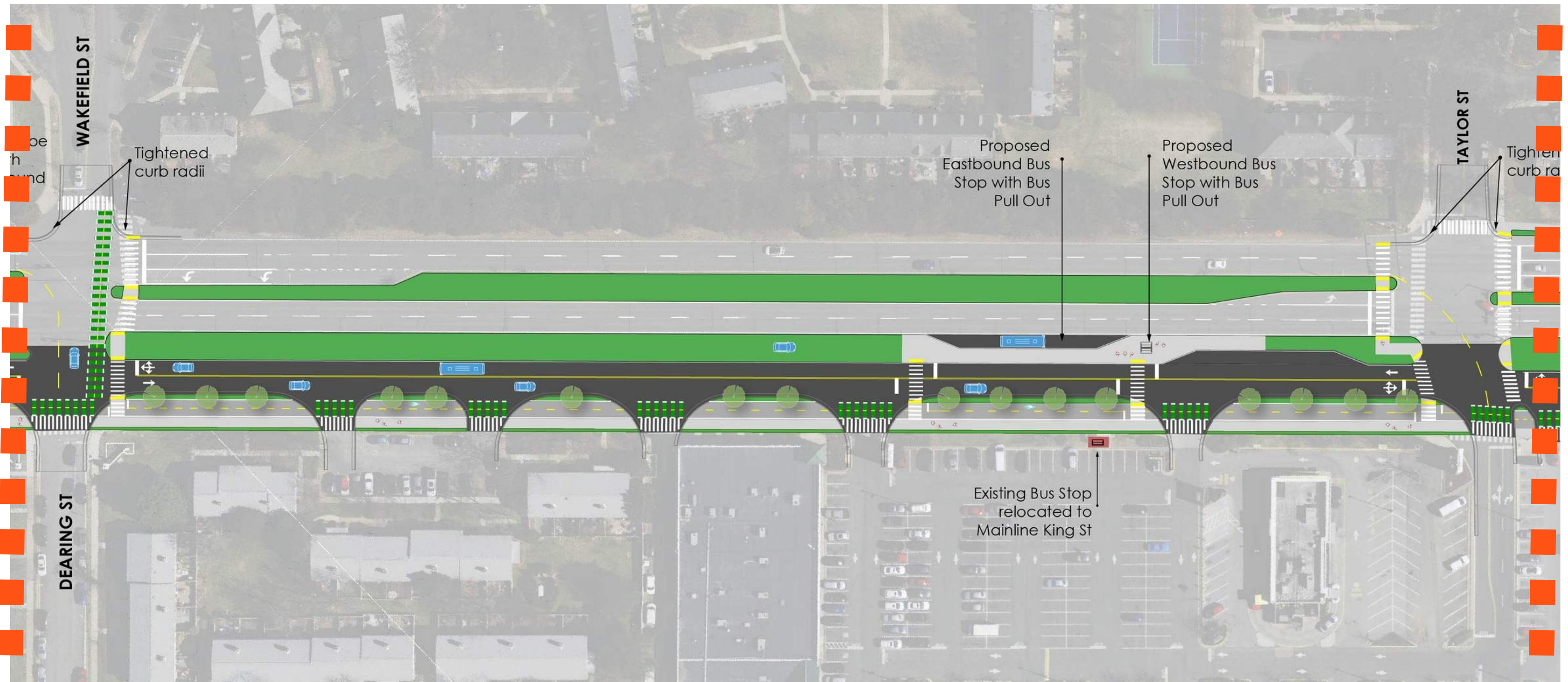

N. Dearing St

Taylor St

Alternative 1: Two-Way Traffic with Transit

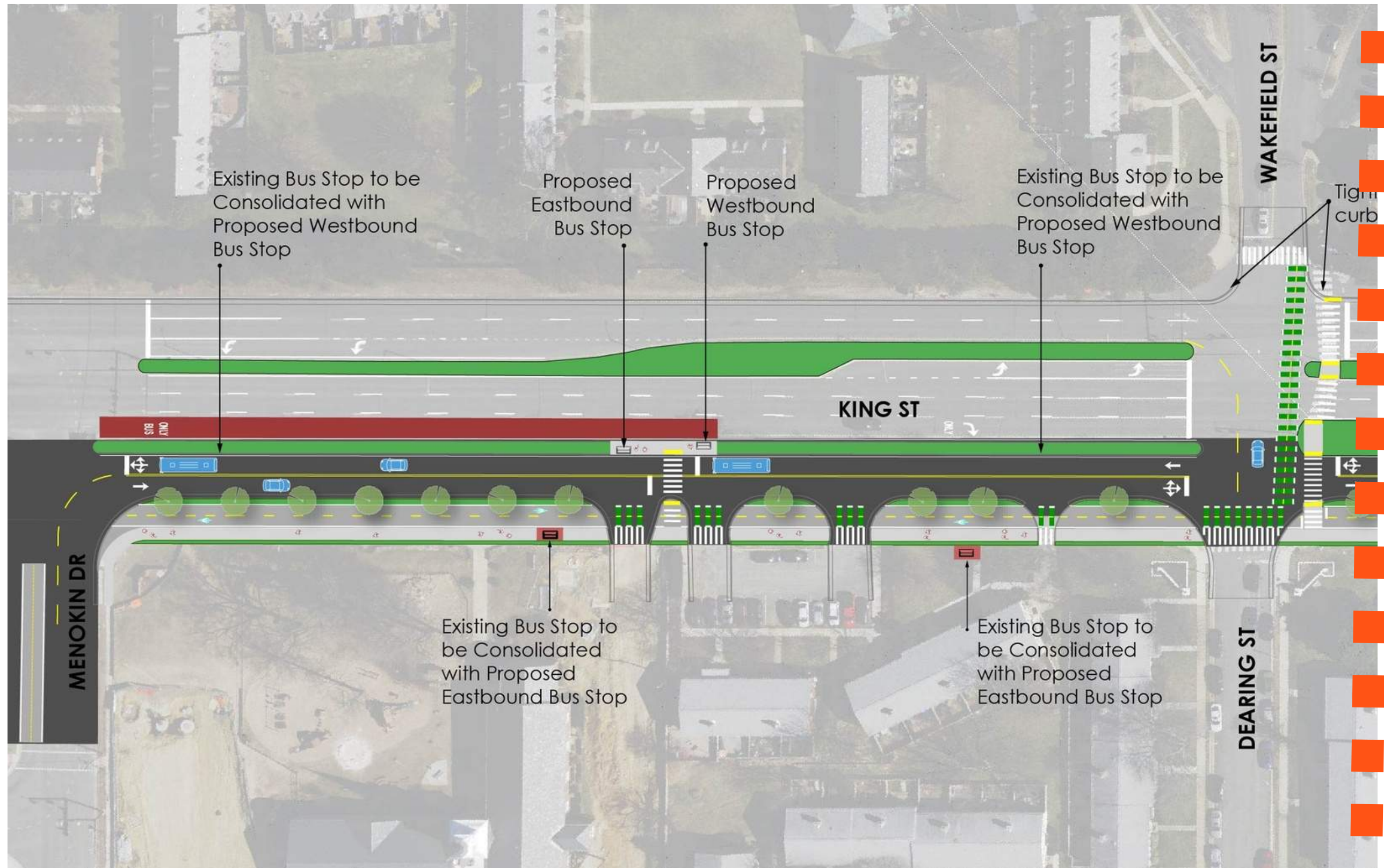

Menokin Dr

N. Dearing St

Full Corridor Design

Alternative 2: One-Way Traffic & Bus Lane

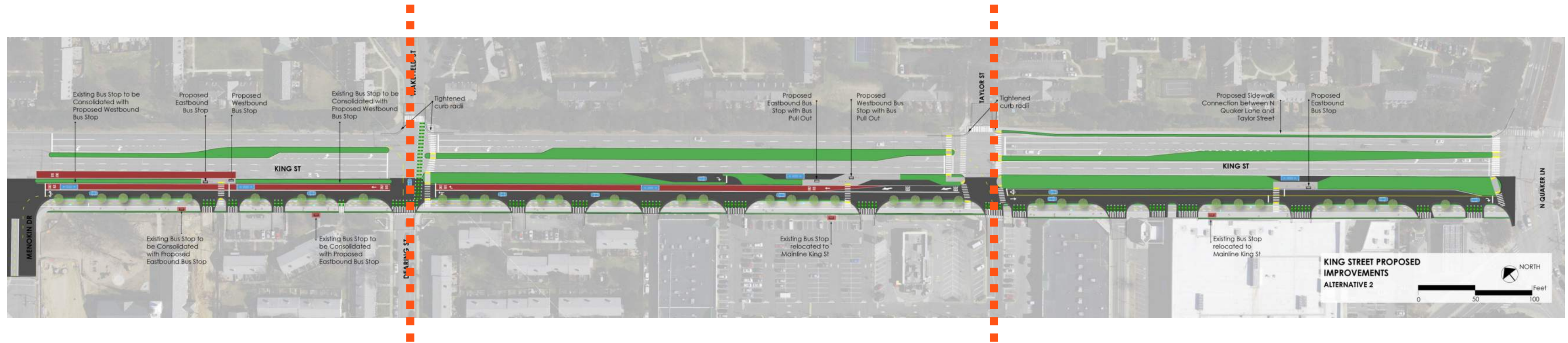

Menokin Dr

N. Dearing St

Taylor Street

N. Quaker Ln

Alternative 2: One-Way Traffic & Bus Lane

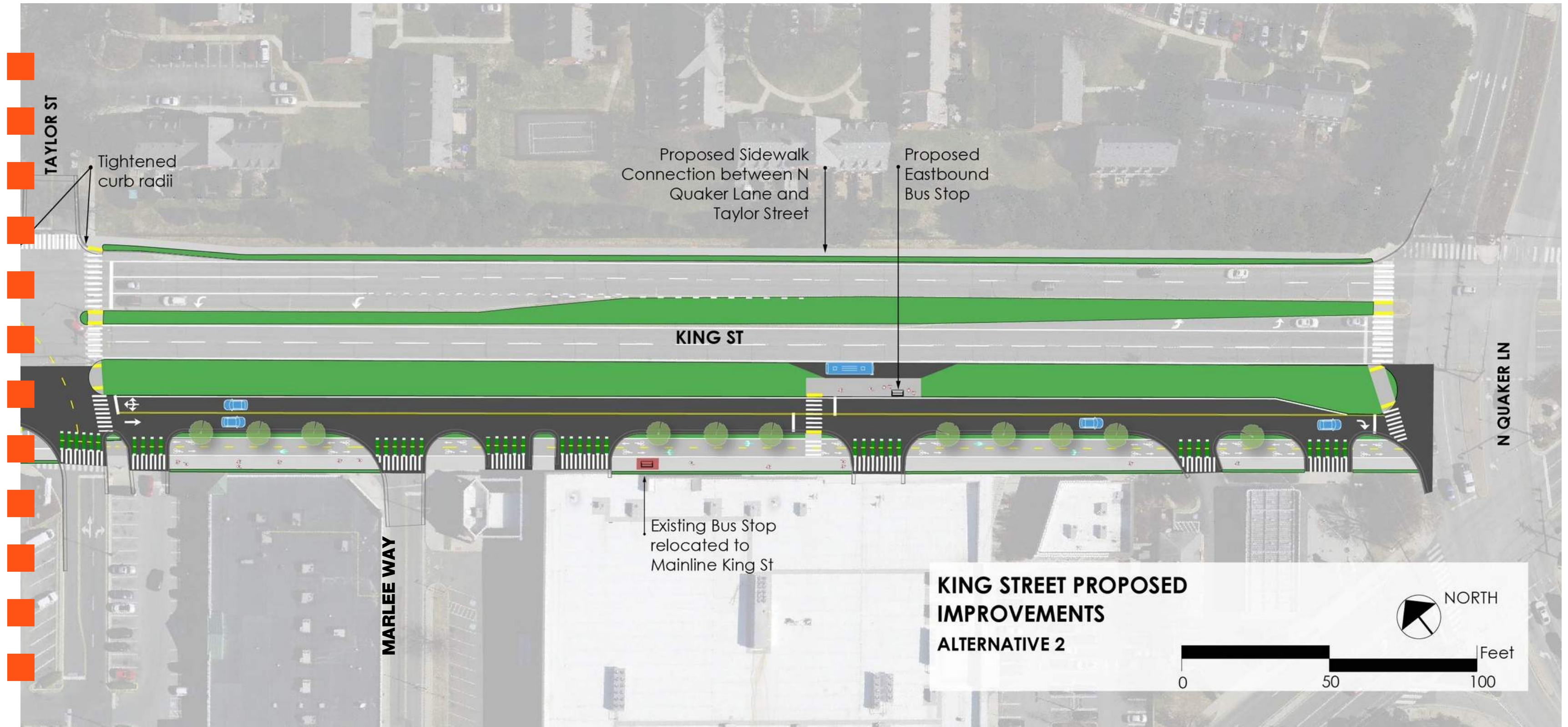

Taylor St

N. Quaker Ln

Alternative 2: One-Way Traffic & Bus Lane

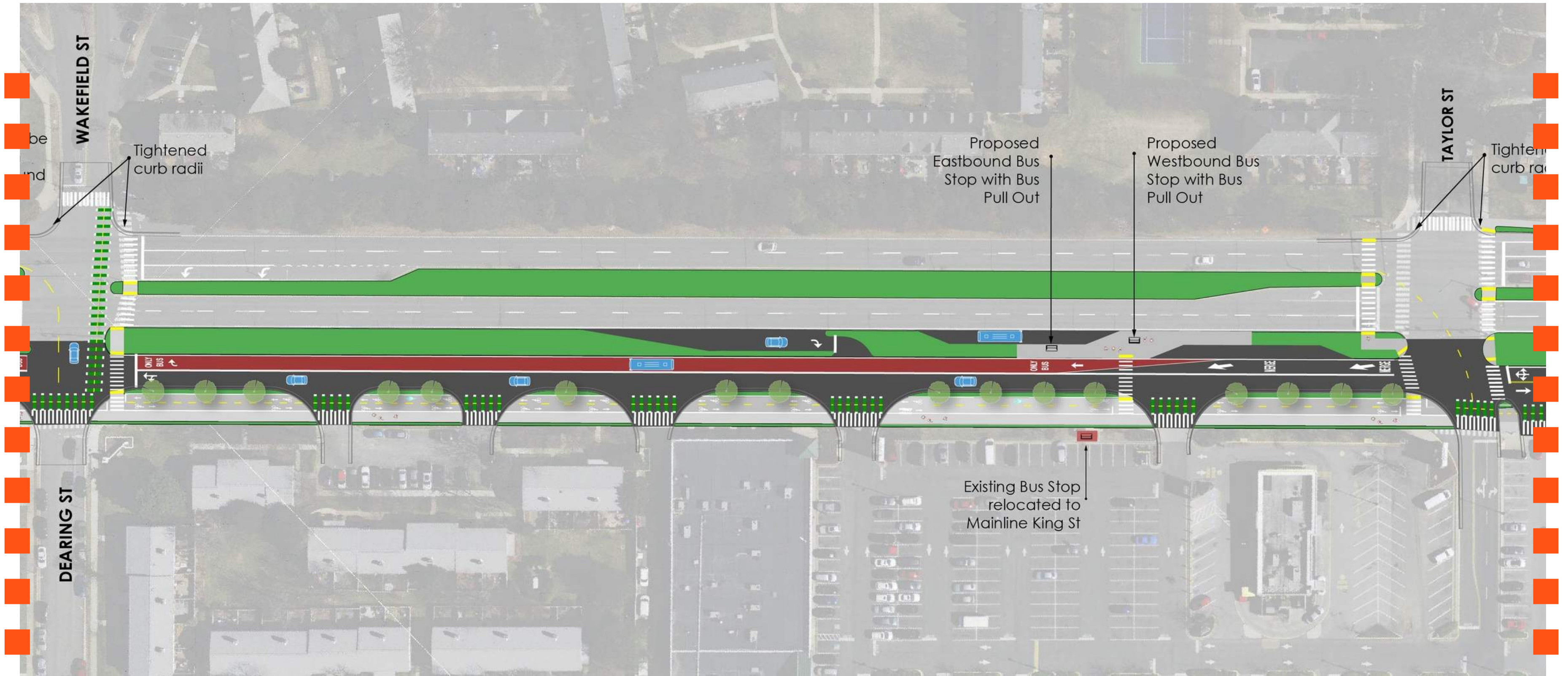

N. Dearing St

Taylor St

Alternative 2: One-Way Traffic & Bus Lane

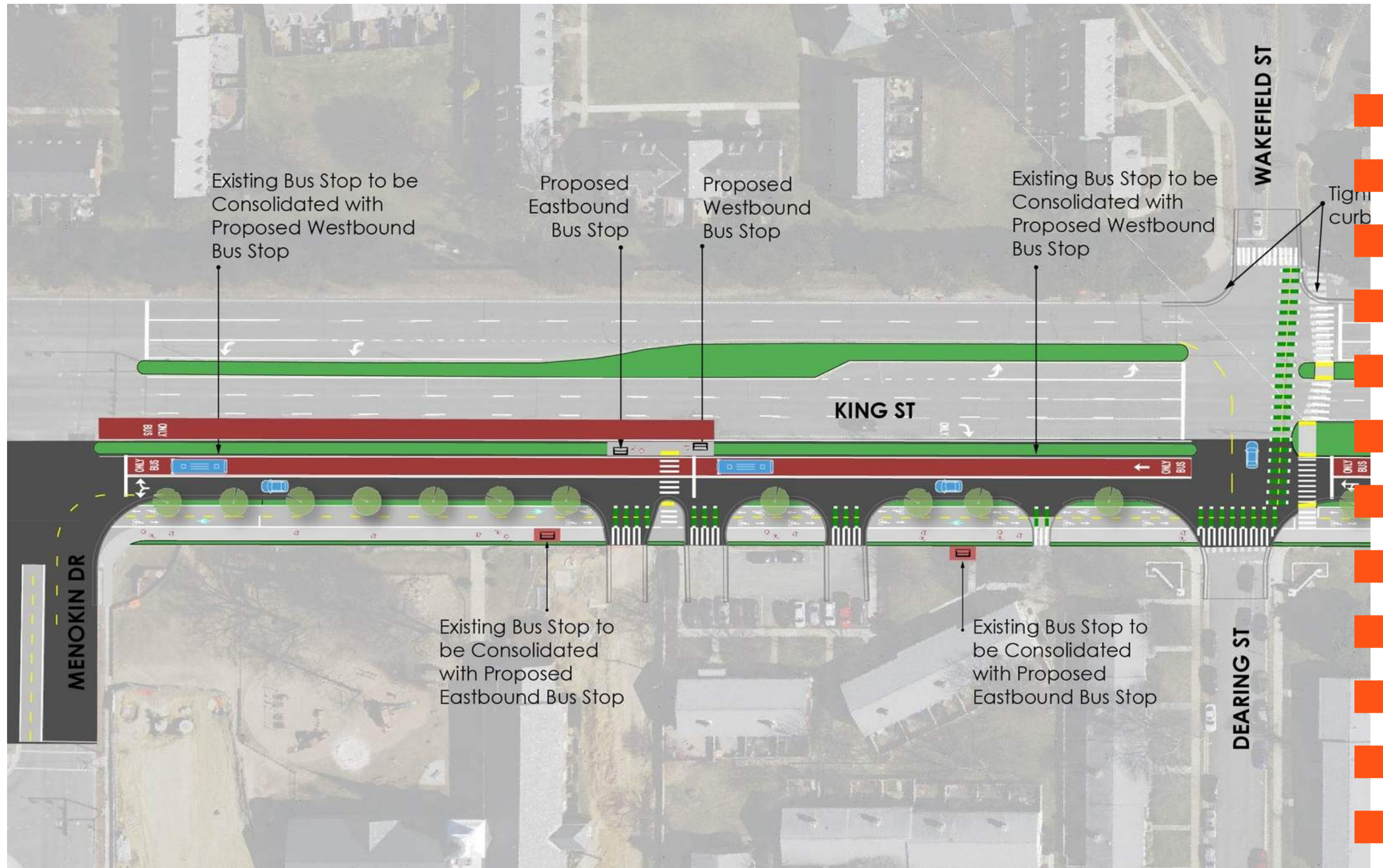

Menokin Dr

N. Dearing St

Community Feedback

Little support for Alternative 3

- Removed from consideration

Access to Safeway and Marlee Way

- Maintain two-way traffic on access road between S Taylor and Quaker

Vehicle Stacking to Bradlee

- Access point into shopping center

Right Turn Lane at North Dearing Street

- Right turn from westbound access road onto mainline King Street

Interim Improvements



- Speed feedback signs
- Curb radii tightening
- No Turn on Red signage
- Pavement markings at intersections



- Bicycle wayfinding signage
- Sharrow symbols
- Pedestrian refuge hardening
- Signal timing adjustments
- Safety improvements at bus shelters



- Tree planting in medians on King Street

Upcoming Activity

Traffic & Parking Board

May: Consideration of Preferred Alternative

Seeking Funding

Summer: Identify and seek funding for long term improvements

Community Meeting

May: Identification of Preferred Alternative & Interim Improvements

Interim Design

Summer: Hire design team for interim improvements and identify funding



Questions & Comments



Sara Brandt-Vorel
Sara.BrandtVorel@AlexandriaVA.gov