

Holmes Run Trail Closure & Detour Informational Signs

Closure Overview Map

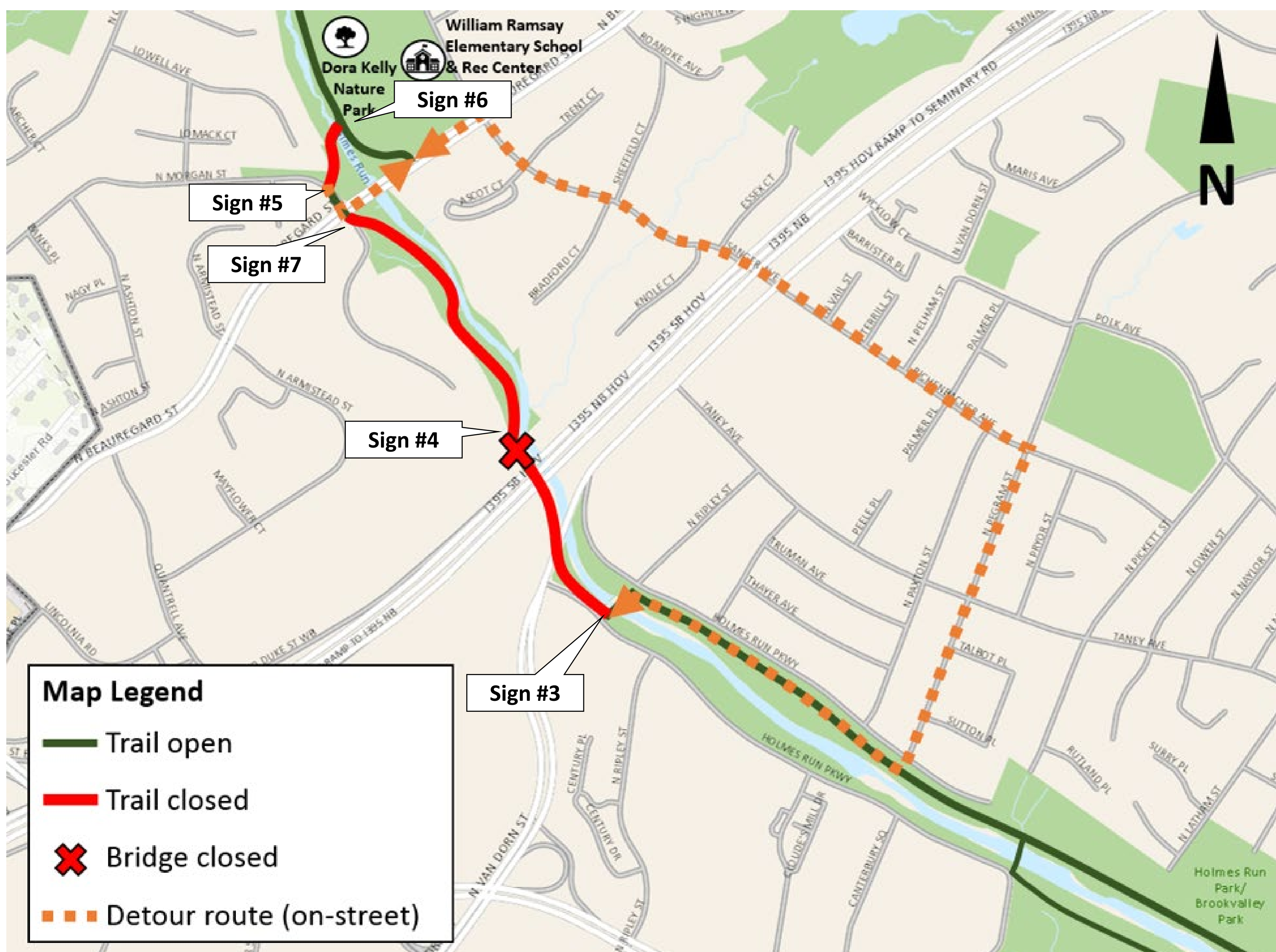

Sign #1 - WB

DANGER BRIDGE CLOSED

This bridge has been damaged by severe flooding and is not safe to use. The City of Alexandria is actively working to repair the affected areas as soon as possible. In the meantime, please use the detour provided to continue on Holmes Run Trail.



For more information on closures and updates on Holmes Run Trail, please visit www.alexandriava.gov/113304.

Sign #2 - EB

DANGER BRIDGE CLOSED

This bridge has been damaged by severe flooding and is not safe to use. The City of Alexandria is actively working to repair the affected areas as soon as possible. In the meantime, please use the detour provided to continue on Holmes Run Trail.



For more information on closures and updates on Holmes Run Trail, please visit www.alexandriava.gov/113304.

Sign #3 - WB

DANGER TRAIL CLOSED

This trail and the bridge ahead have been damaged by severe flooding and are not safe to use. The City of Alexandria is actively working to address this issue as soon as possible. In the meantime, please use the detour provided to continue on Holmes Run Trail.

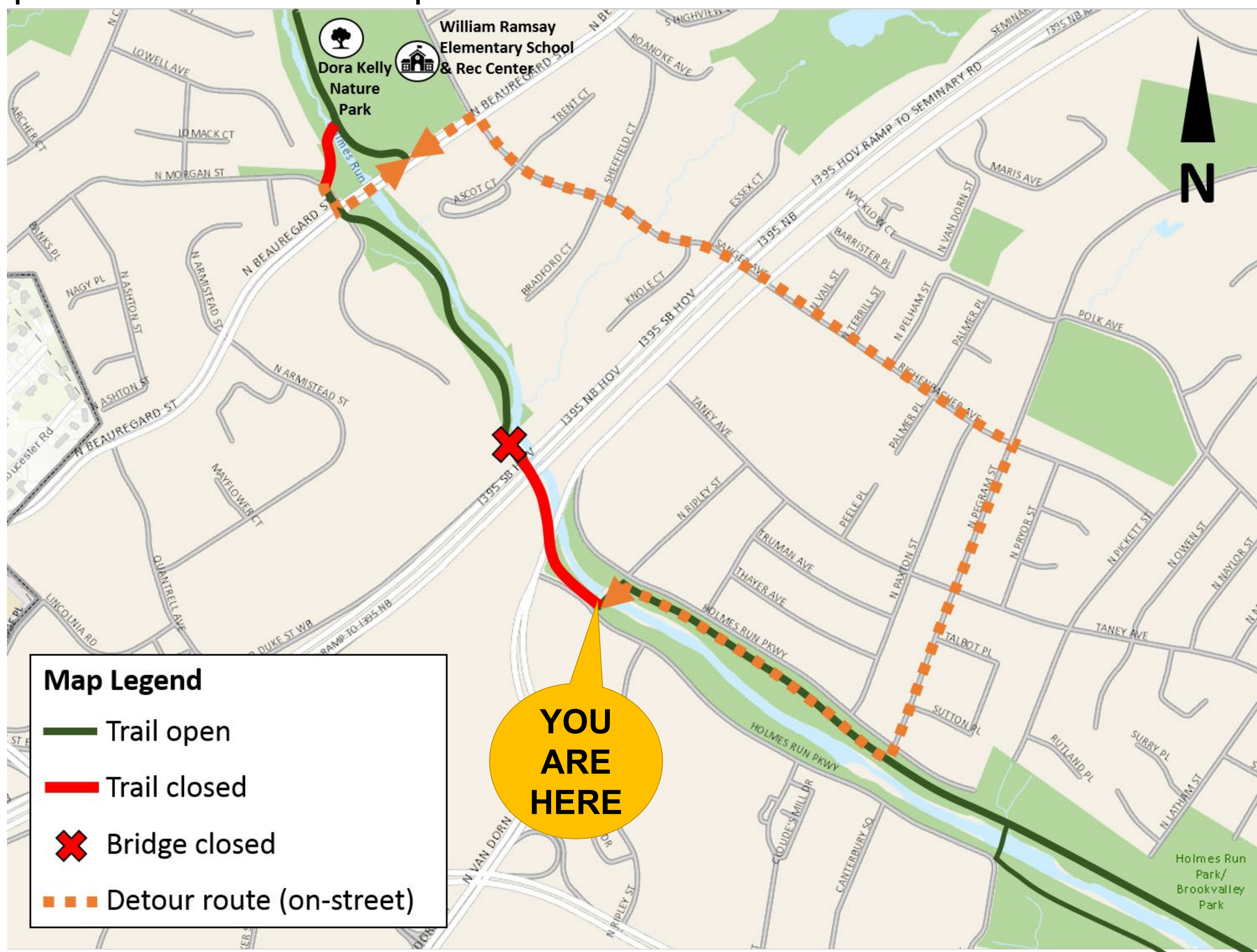

For more information on closures and updates on Holmes Run Trail, please visit www.alexandriava.gov/113304.

Sign #4 - EB

DANGER BRIDGE CLOSED

This bridge and the trail ahead have been damaged by severe flooding and are not safe to use. The City of Alexandria is actively working to address this issue as soon as possible. In the meantime, please use the detour provided to continue on Holmes Run Trail.

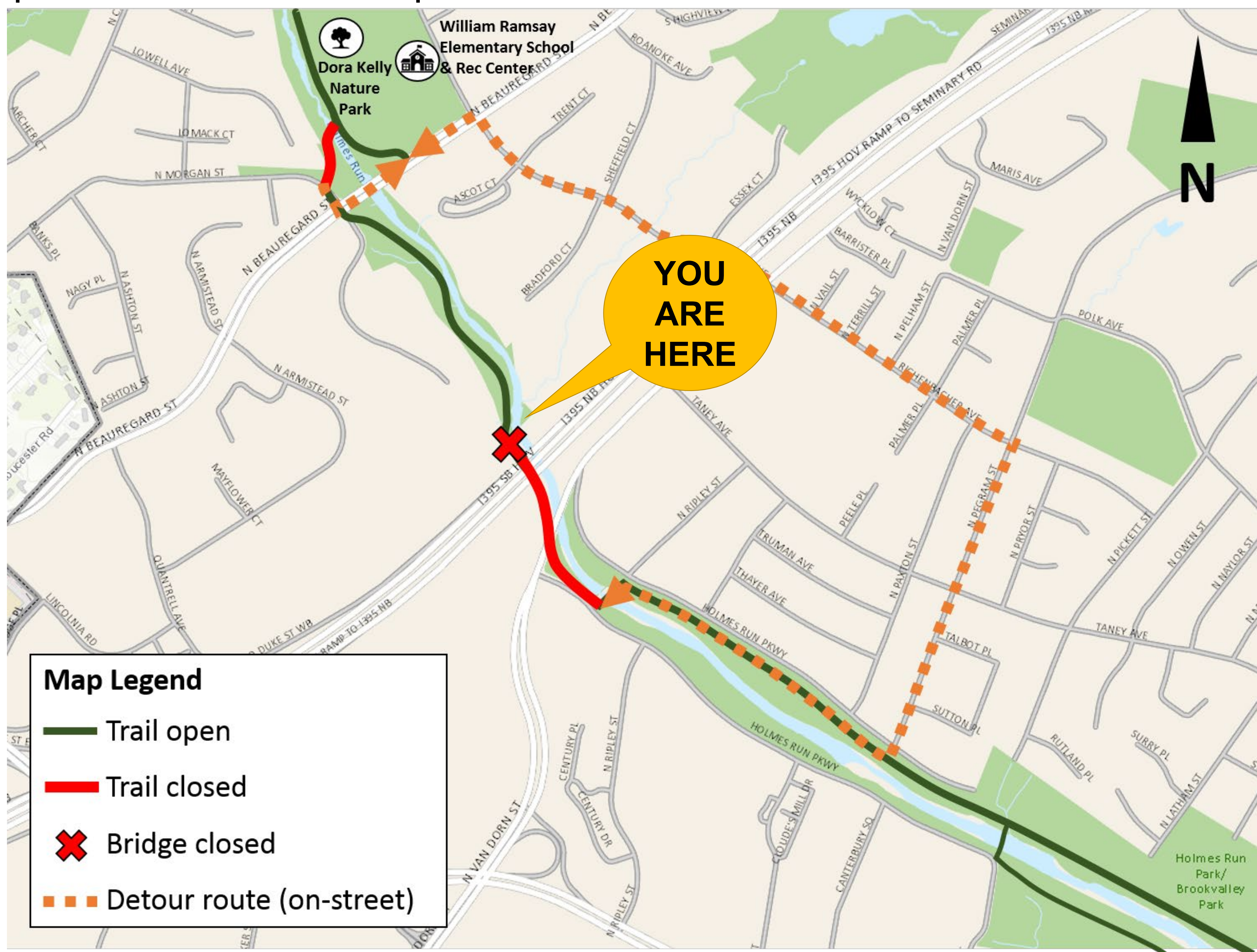

For more information on closures and updates on Holmes Run Trail, please visit www.alexandriava.gov/113304.

Sign #5 - WB

DANGER TRAIL CLOSED

This trail has been damaged by severe flooding and is not safe to use. The City of Alexandria is actively working to address this issue as soon as possible. In the meantime, please use the detour provided to continue on Holmes Run Trail.



For more information on closures and updates on Holmes Run Trail, please visit www.alexandriava.gov/113304.

Sign #6 - EB

DANGER TRAIL CLOSED

This trail has been damaged by severe flooding and is not safe to use. The City of Alexandria is actively working to address this issue as soon as possible. In the meantime, please use the detour provided to continue on Holmes Run Trail.

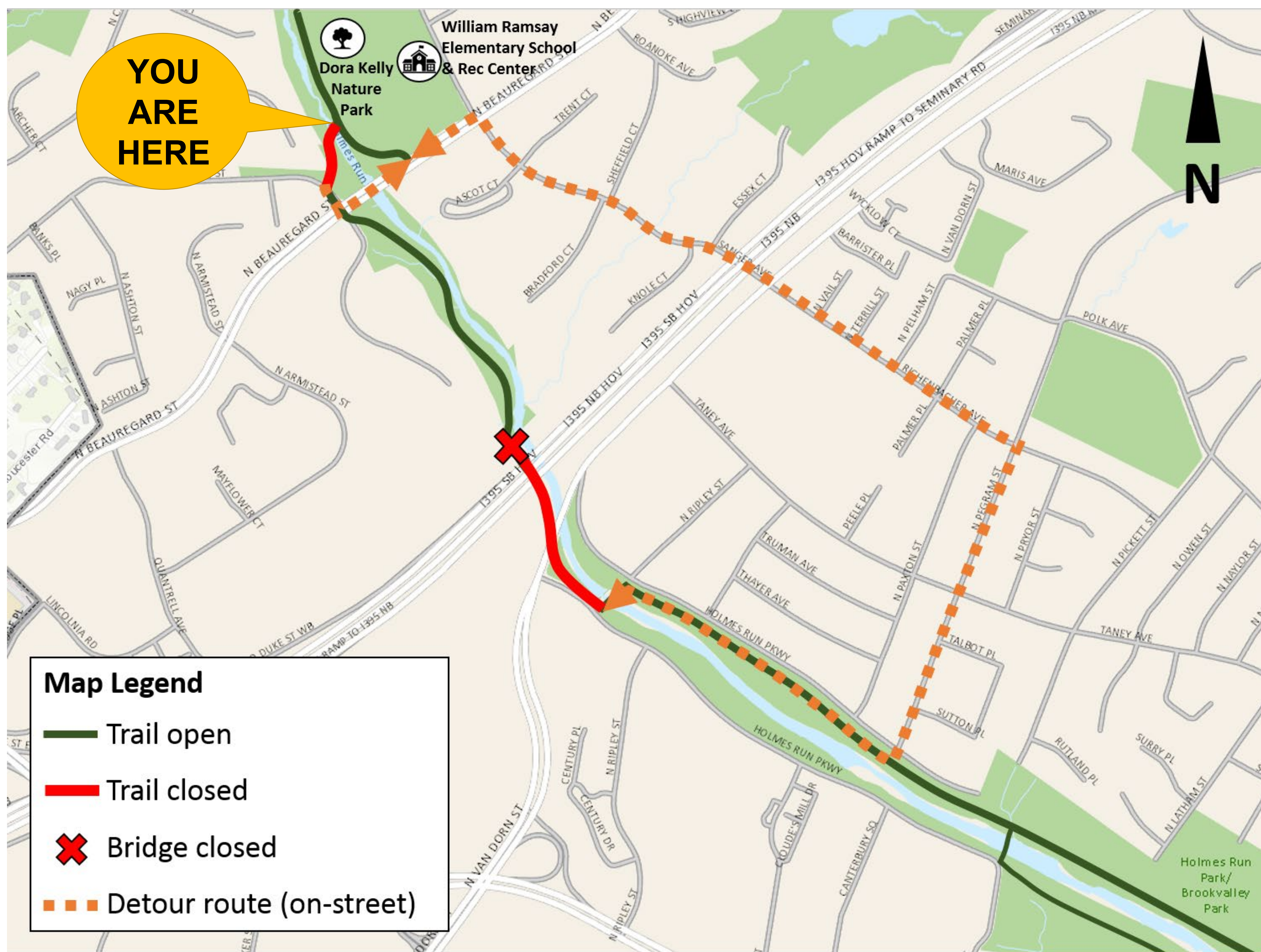

For more information on closures and updates on Holmes Run Trail, please visit www.alexandriava.gov/113304.

