

BROKEN CONCRETE HEADWALL

NOTE: THE LIMITS OF DISTURBANCE HAVE BEEN REVISED TO MINIMIZE ADJACENT WETLAND AND TREE IMPACTS TO THE MAXIMUM EXTENT PRACTICABLE. WETLANDS OUTSIDE THE PROJECT PERIMETER WILL NOT BE DISTURBED OR IMPACTED.

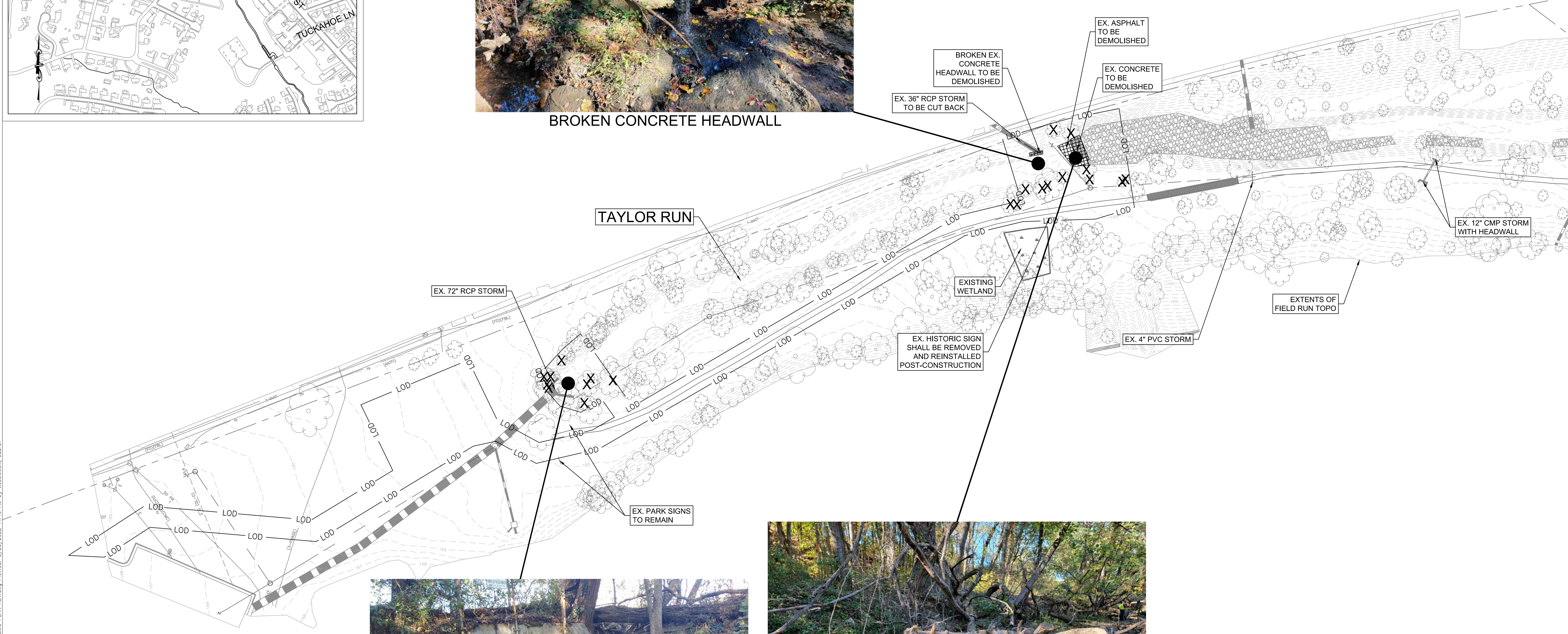

EROSION ADJACENT TO CONCRETE HEADWALL



WOODY DEBRIS ACROSS UNSTABLE EXPOSED SANITARY SEWER CROSSING

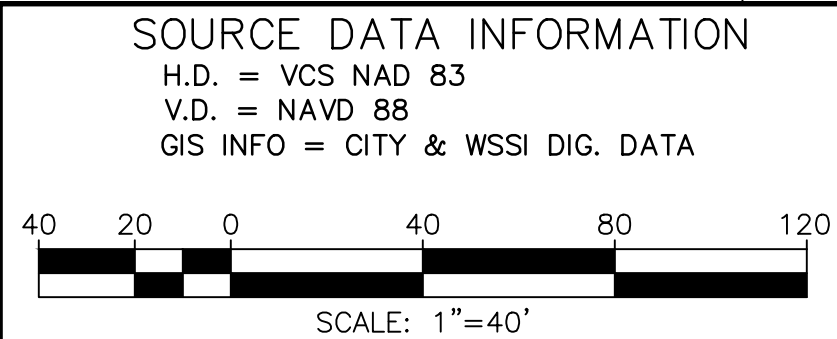
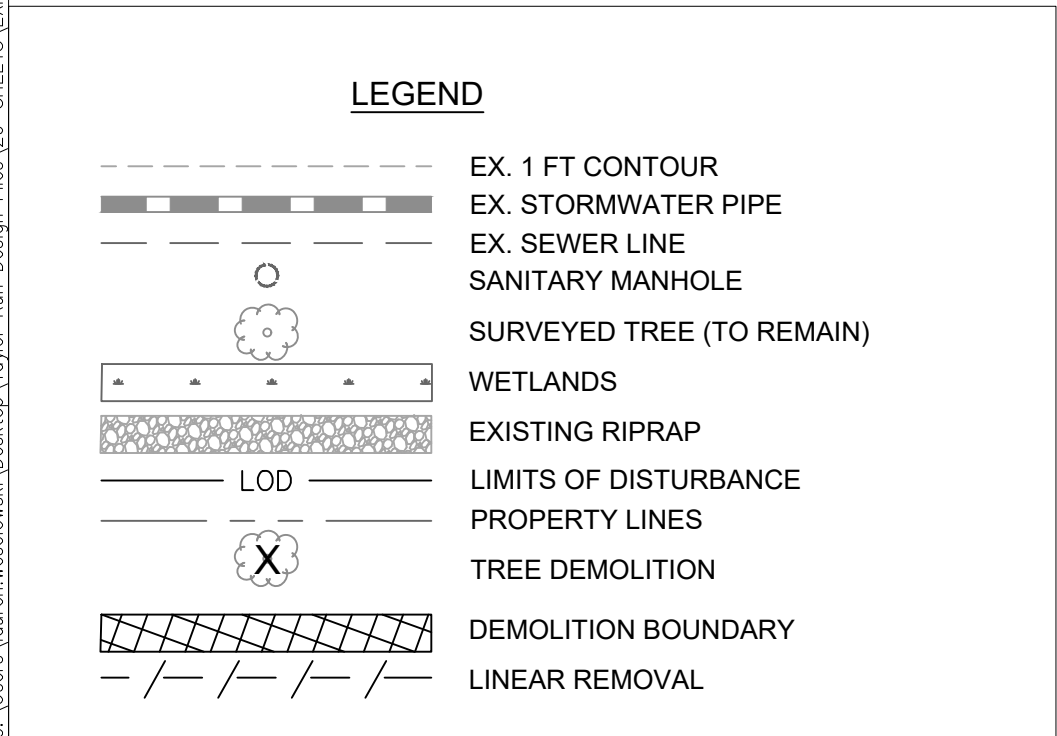

CONCEPTUAL DESIGN

CITY OF ALEXANDRIA, VIRGINIA
DEPARTMENT OF PROJECT IMPLEMENTATION
301 KING ST., RM 3200
ALEXANDRIA, VA 22314

REVISIONS	DATE	DESCRIPTION

CITY PROJECT NO.: TO-41
DATE OF PLAN ISSUANCE: XX/XX/XX
CONSULTANT PROJECT ID.: 60668730
DESIGNED BY: ST DATE: 7/19/22
DRAWN BY: ST DATE: 7/19/22
CHECKED BY: BWA DATE: 7/19/22
APPROVED BY: BWA DATE: 7/19/22

MINIMAL INTERVENTION
EXISTING CONDITIONS

URS
1400 MISTING CENTER DR., SUITE 100
GERMANTOWN, MD 20876
(301) 351-2000

TAYLOR RUN STREAM STABILIZATION

DRAWING
EX - 01

SCALE 1"=40'
SHEET 1 OF 5

C:\Users\lauren.wesolowski\Desktop\Taylor Run Design Files\20-SHEETS\EXISTING CONDITIONS AND DEMO PLAN REV.dwg Plotted: 8/25/2022 3:30 PM by Wesolowski, Lauren



*Site shall be replanted at 600 stems/acre



SOURCE DATA INFORMATION
H.D. = VCS NAD 83
V.D. = NAVD 88
GIS INFO = CITY & WSSI DIG. DATA

40 20 0 40 80 120



SCALE: 1"=40'

