

M:\Projects\2014\14103\_HolmesRunTrail\CAD\CAD\Plan\17-PLAN & PROFILE A.dwg Feb 27, 2015 - 11:42am RKK\_SITLCTB Plot Scale 1:1 Plot By: rrose Tab: Plan Profile A

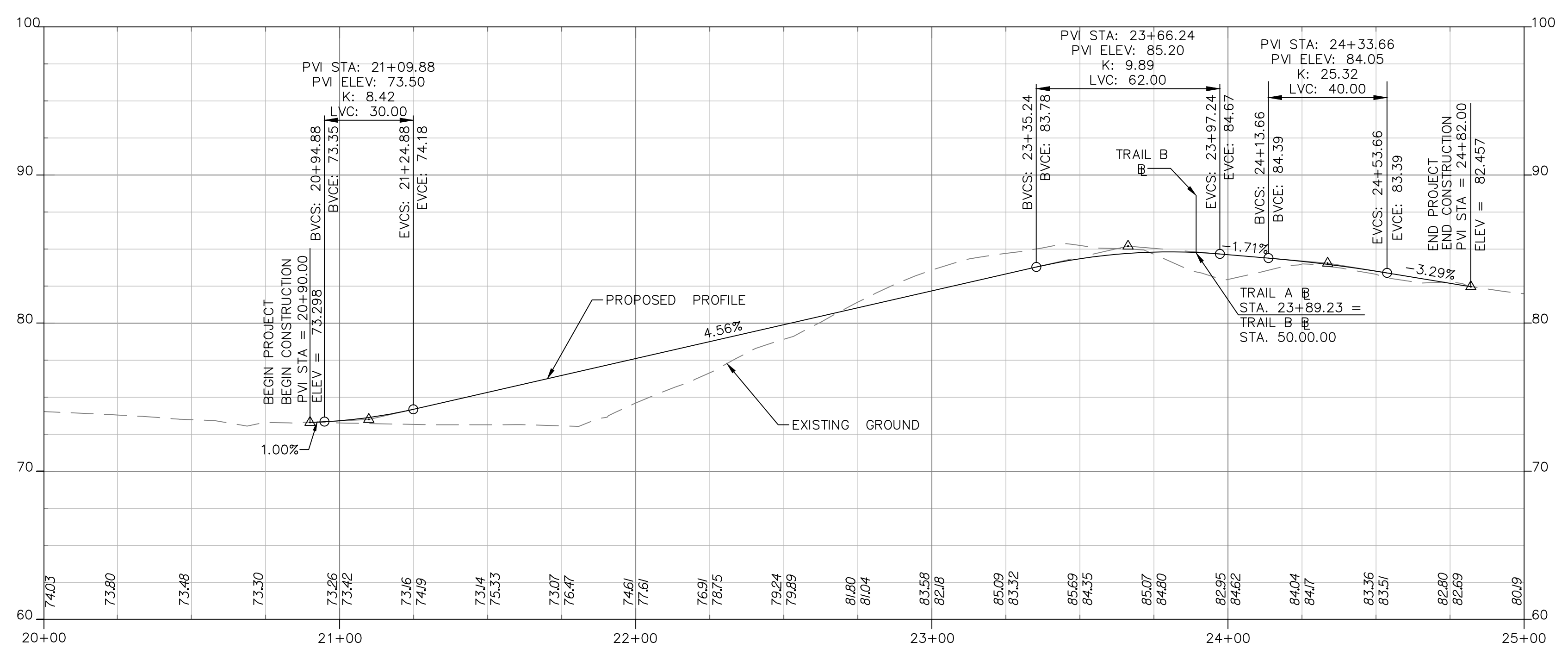
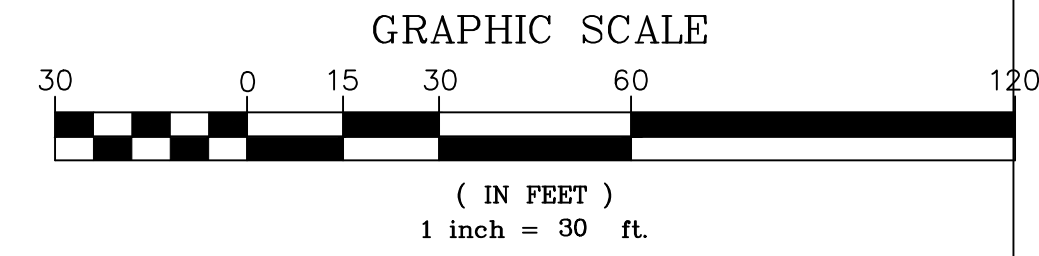
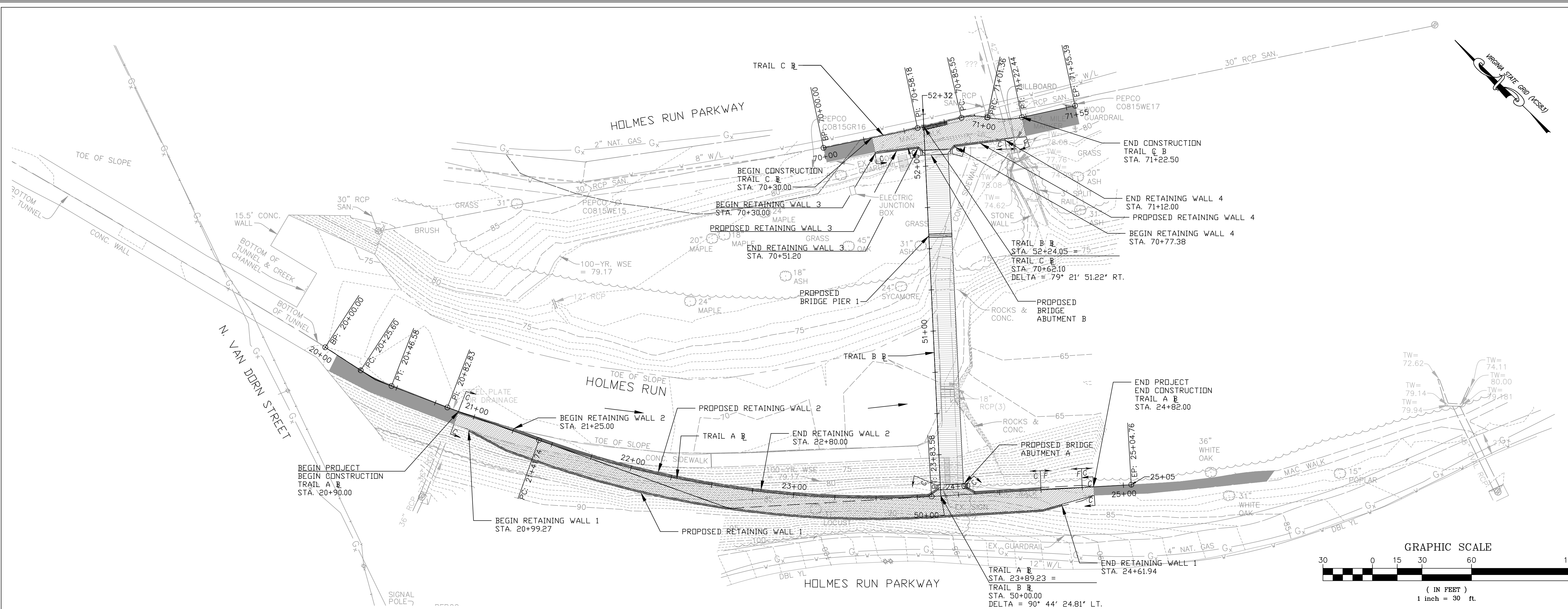

**LEGEND**

	PROPOSED ASPHALT TRAIL
	PROPOSED BRIDGE
	EXISTING TRAIL TO REMAIN

REVISIONS    	<h2 style="margin: 0;">TRAIL A PLAN &amp; PROFILE</h2>	Sheet: 17
Scale: 1" = 30' Project:		
<h3 style="margin: 0;">Transportation &amp; Environmental Services Engineering &amp; Design Division P.O. Box 178 Alexandria, Va. 22313</h3>		
<h2 style="margin: 0;">HOLMES RUN BIKE TRAIL</h2>		

M:\projects\2014\14103\_HolmesRunTrail\CAD\Drawings\18-PLAN & PROFILE B & C.dwg Feb 27, 2015 - 11:52am RKK\_SITE.CTB Plot Scale 1"=1' Plot By: rrcase Tab:PLAN PROFILE B C

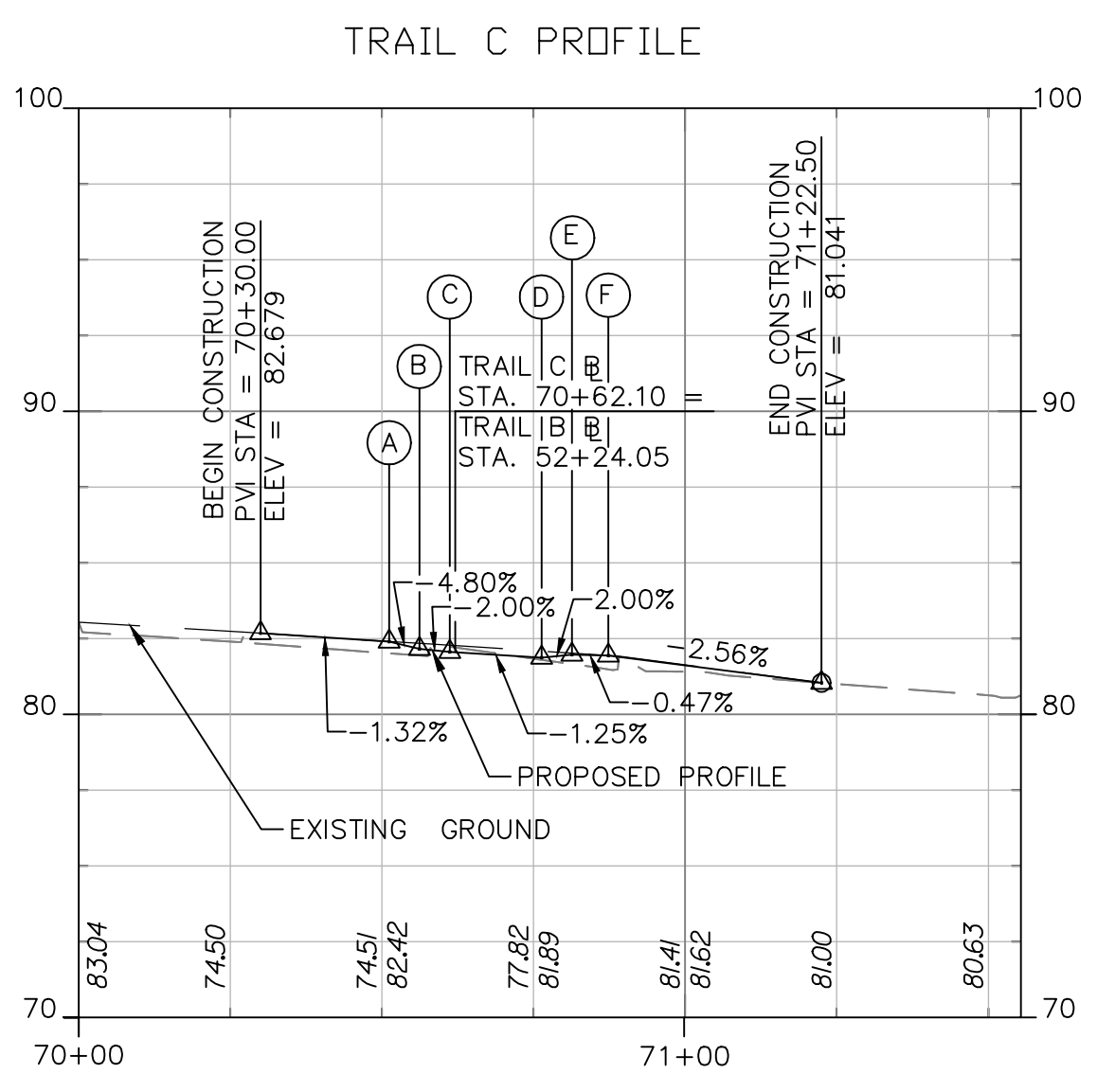
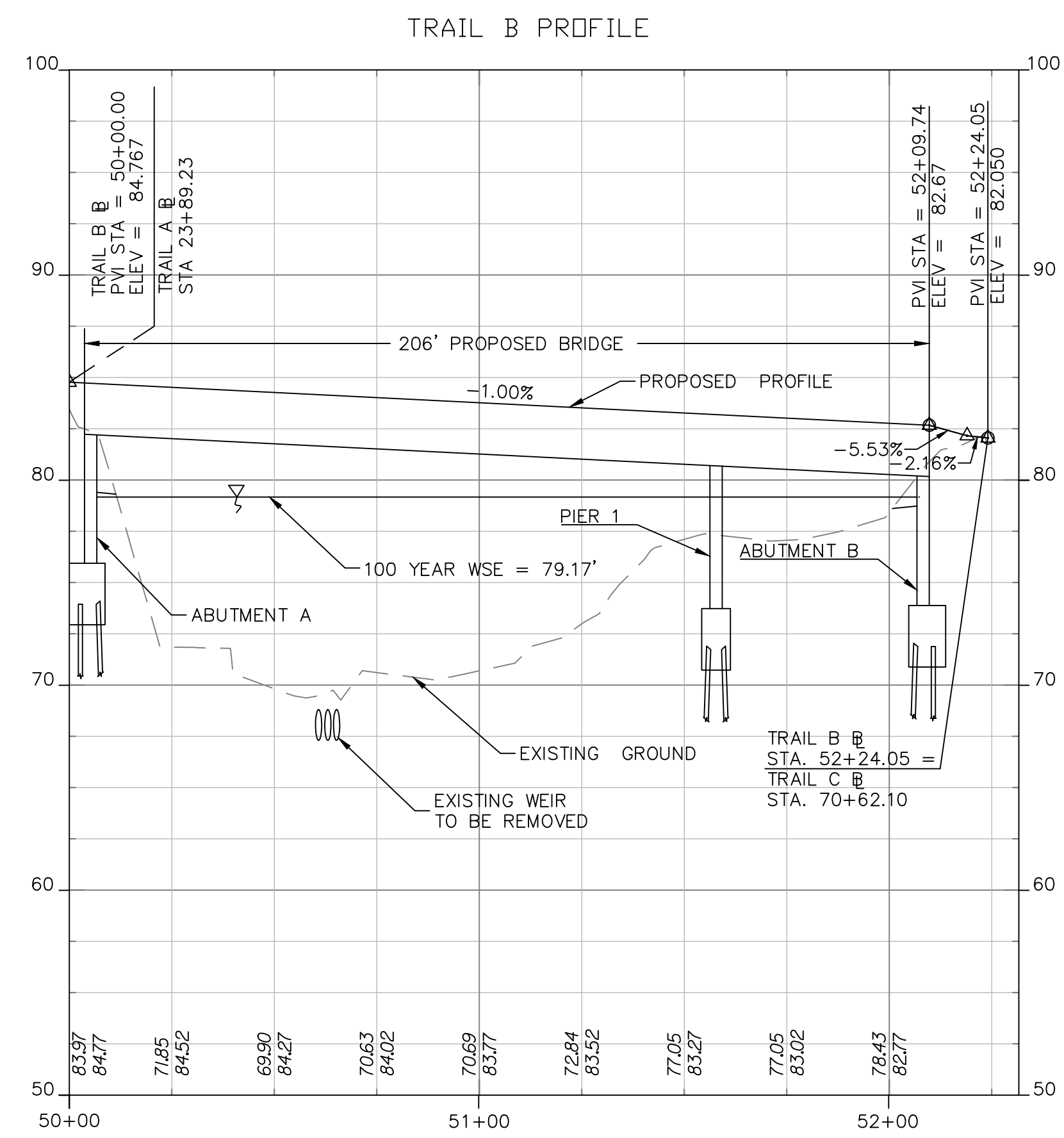
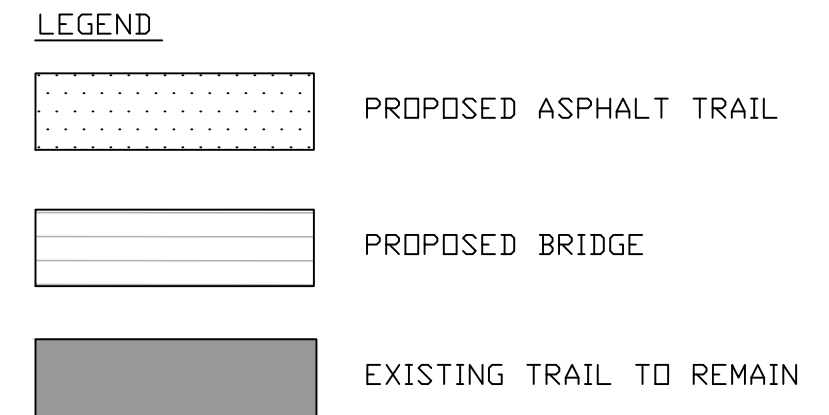
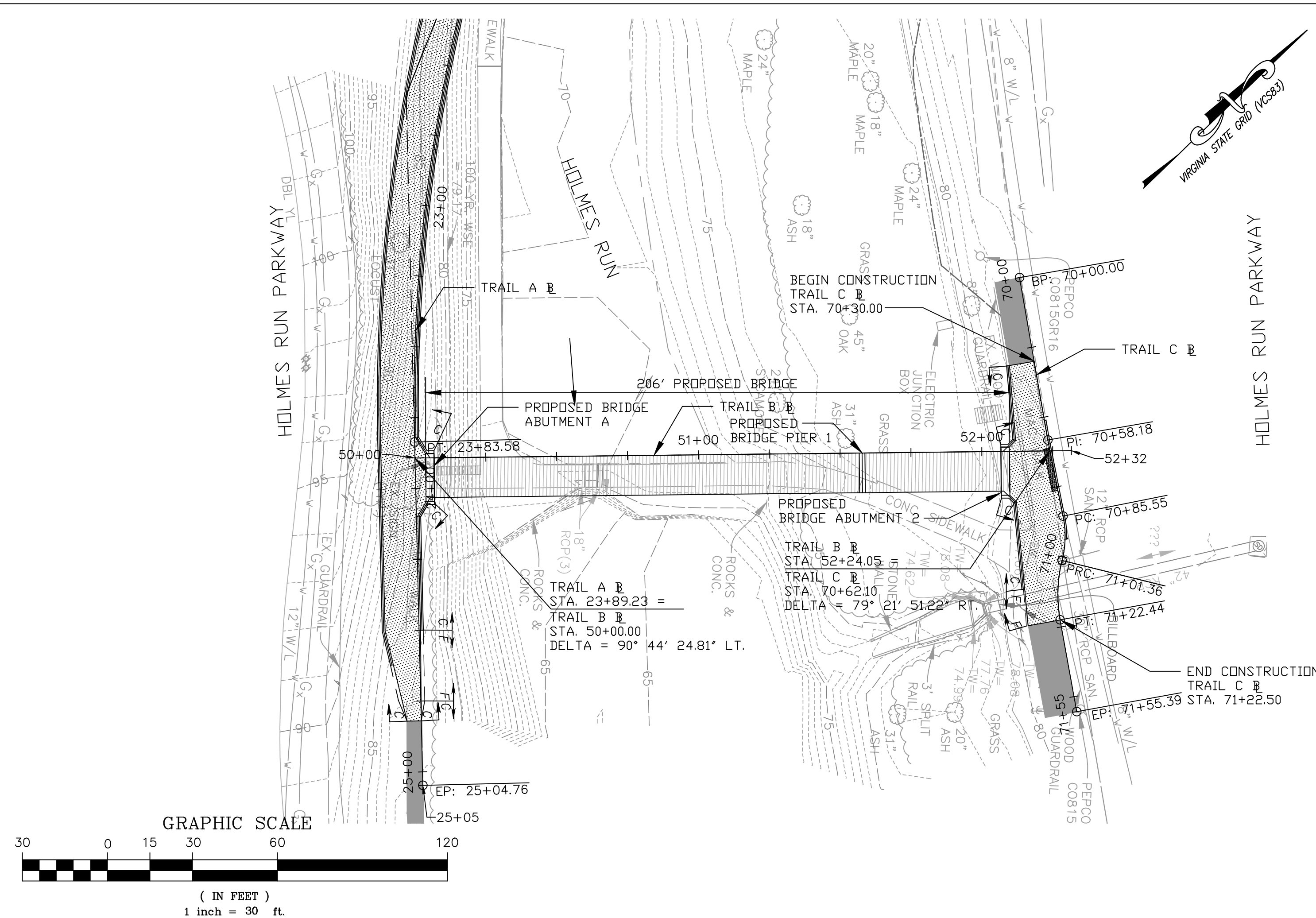

**TRAIL C PVI STATION AND ELEVATIONS**

(A)	STA. 70+51.20,	ELEV = 82.40'
(B)	STA. 70+56.20,	ELEV = 82.16'
(C)	STA. 70+61.20,	ELEV = 82.06'
(D)	STA. 70+76.35,	ELEV = 81.87'
(E)	STA. 70+81.34,	ELEV = 81.97'
(F)	STA. 70+87.34,	ELEV = 81.94'
(G)	STA. 71+22.50,	ELEV = 81.04'

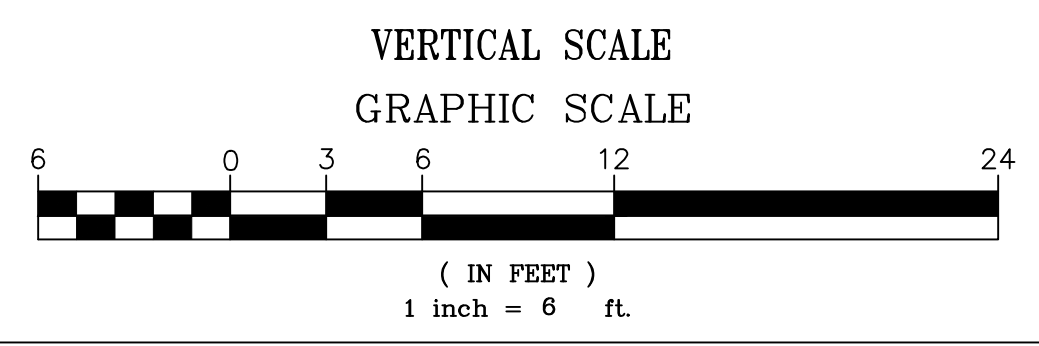
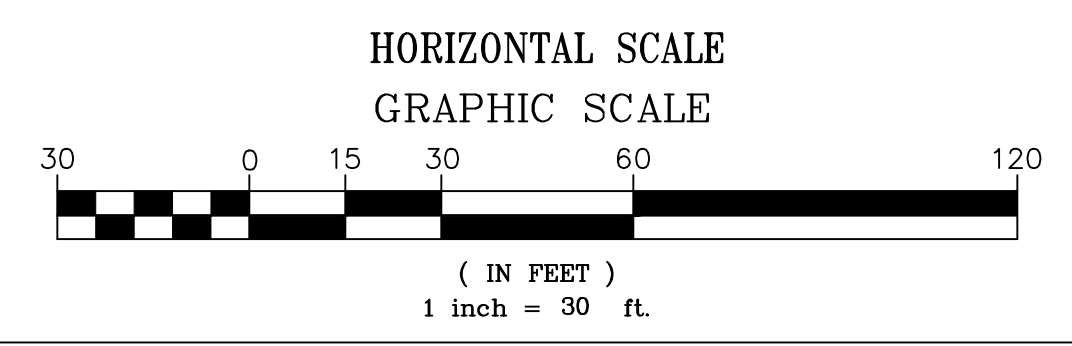

**REVISIONS**

**TRAILS B AND C  
PLAN & PROFILES**

Scale: 1" = 30' Project: Holmes Run Bike Trail

Transportation & Environmental Services  
Engineering & Design Division  
P.O. Box 178 Alexandria, Va. 22313

**HOLMES RUN BIKE TRAIL**

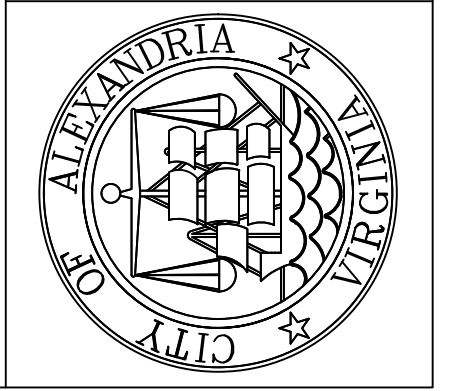

M:\projects\2014\14103\_HolmesRunTrail\CAD\2D\Plan\22-STREAM\_STAB.dwg Feb. 27, 2015 - 1:21pm RKK\_SITE.CTB Plot Scale: 1=1 Plot By: mross Tab: Layout1

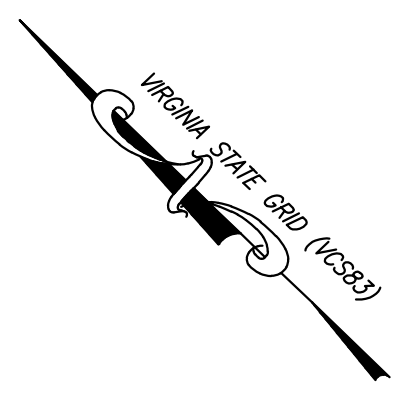
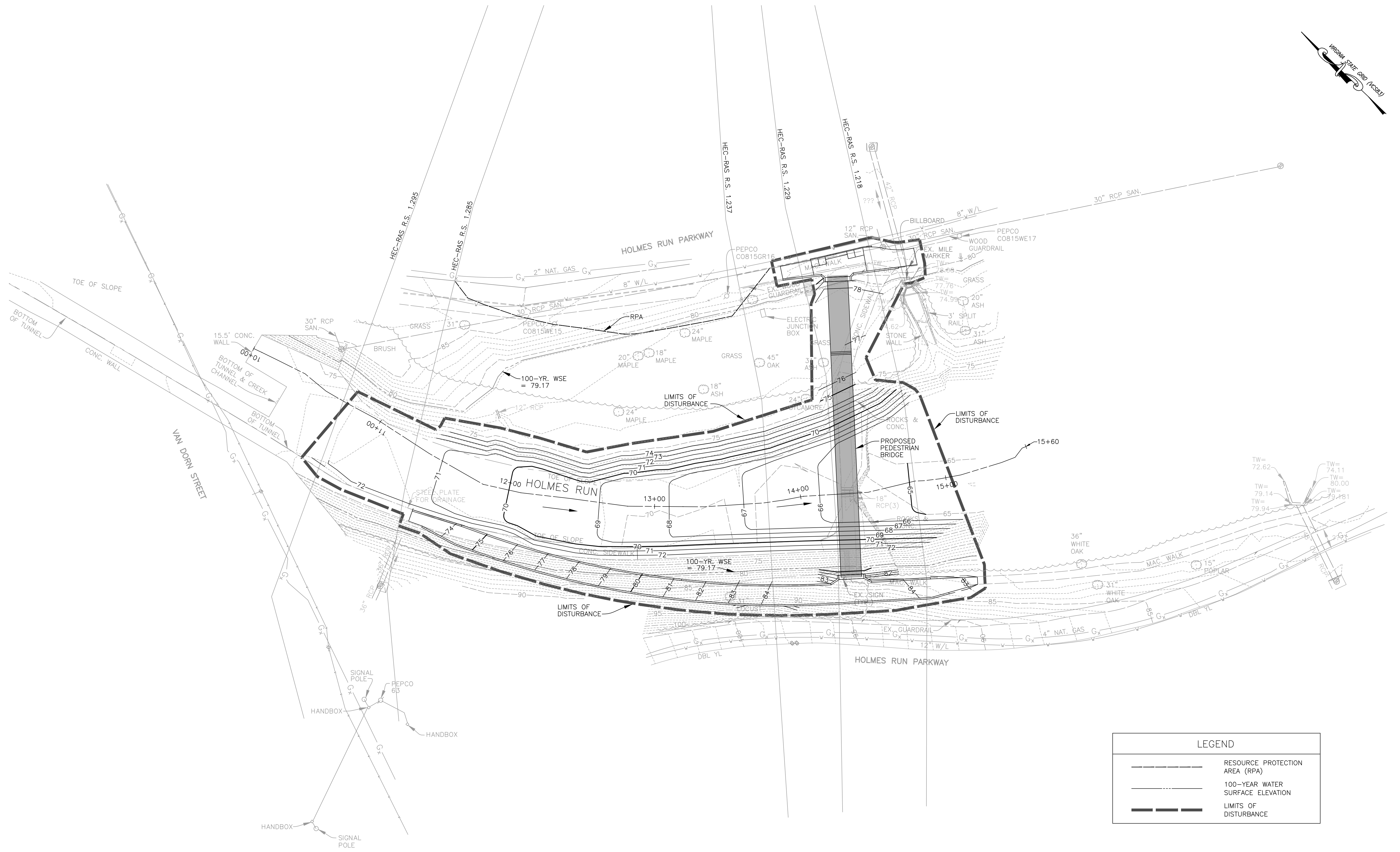

LEGEND	
-----	RESOURCE PROTECTION AREA (RPA)
-----	100-YEAR WATER SURFACE ELEVATION
-----	LIMITS OF DISTURBANCE

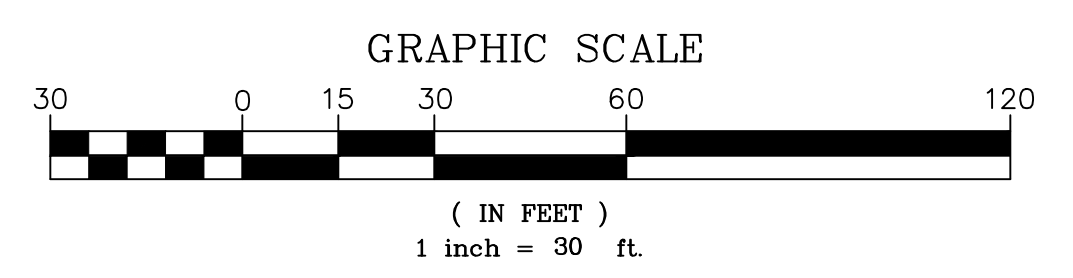

REVISIONS

STREAM STABILIZATION PLAN

Transportation & Environmental Services  
 Engineering & Design Division  
 P.O. Box 178 Alexandria, Va. 22313

HOLMES RUN BIKE TRAIL

